

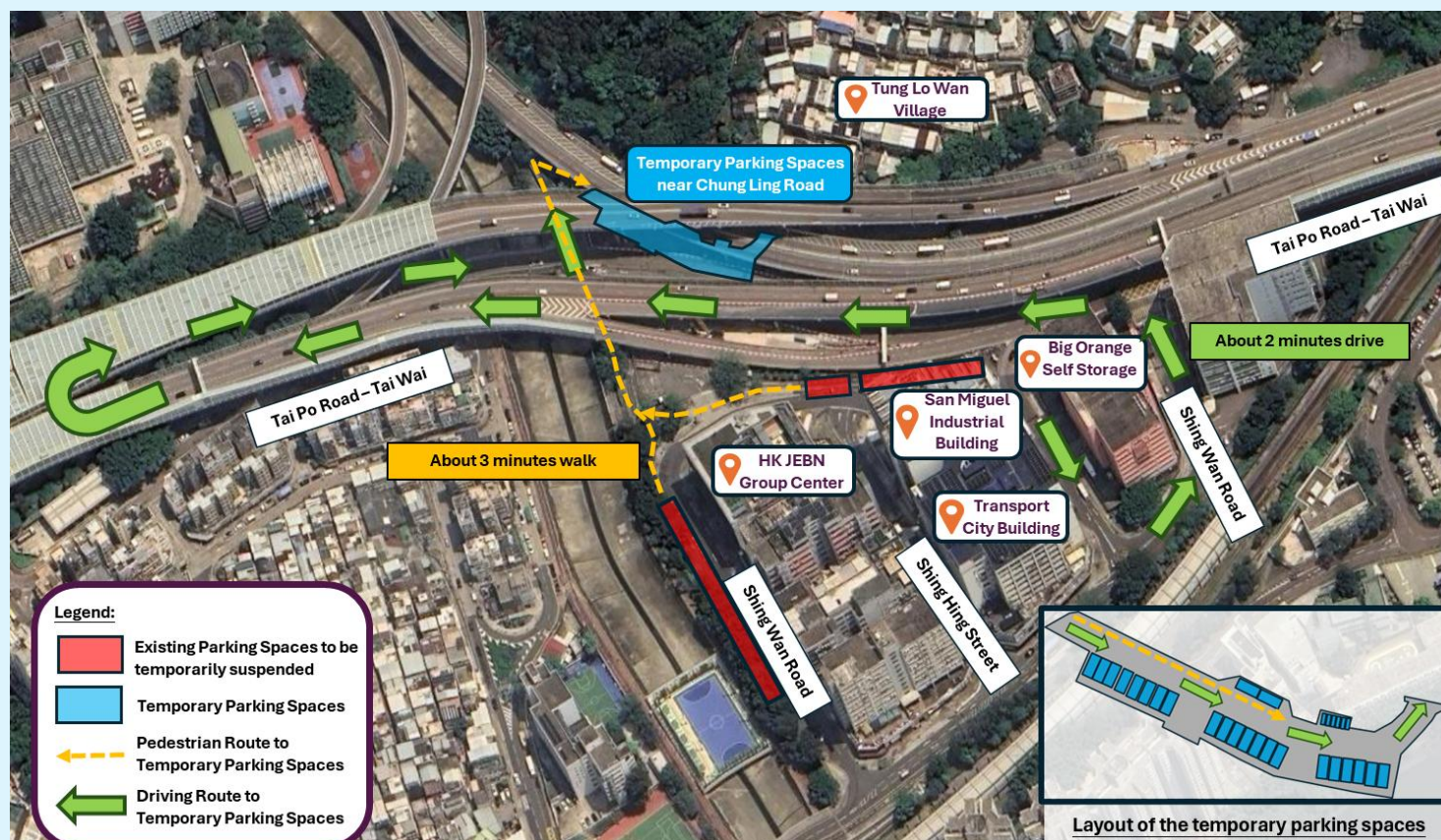

Temporary Arrangement for Parking Spaces on Shing Wan Road and Chung Ling Road

Implementation Time: From 3 January 2026 (Sat) 08:00 am to End of 2029

- To facilitate the construction of the Sha Tin Trunk Road T4, construction of viaducts will be carried out at Shing Wan Road. 23 private car metered parking spaces and 6 motorcycle parking spaces on Shing Wan Road will be temporarily suspended from 3 January 2026 (indicated in **red** in the figure).
- Motorists may use the temporary private car metered parking spaces and motorcycle parking spaces near Chung Ling Road (indicated in **blue** in the figure).
- Appropriate traffic signs will be provided on site to guide motorists.



For any enquiries, please call the project hotline.



9391 1754