

Temporary Traffic Arrangement at Tai Po Road – Tai Wai

Effective Date: From 24 April 2026 to Completion of Works

- To facilitate the construction of viaducts, sections of Tai Po Road – Tai Wai (Westbound and Eastbound) will be temporarily closed **(indicated in red in the figure)**.
- Westbound : Vehicles from Lion Rock Tunnel Road can turn left onto Tai Po Road – Tai Wai via two lanes which will be diverted briefly and then merged at approximately 80 metres ahead. **(indicated in green in the figure)**
- Eastbound: Section of fast lane will be closed. Vehicles heading to the Lion Rock Tunnel Road should keep to the right lane and turn right. **(indicated in blue in the figure)**
- Water-filled barriers will be in place to separate the two-way traffic. Appropriate traffic signs will be installed at the relevant locations to alert and assist motorists.
- For details, please refer to the Transport Department’s traffic notices: https://www.td.gov.hk/tc/traffic_notices

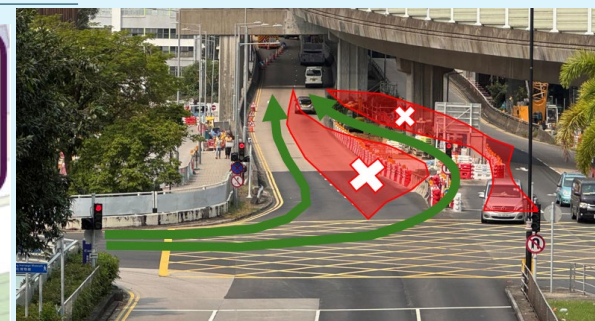
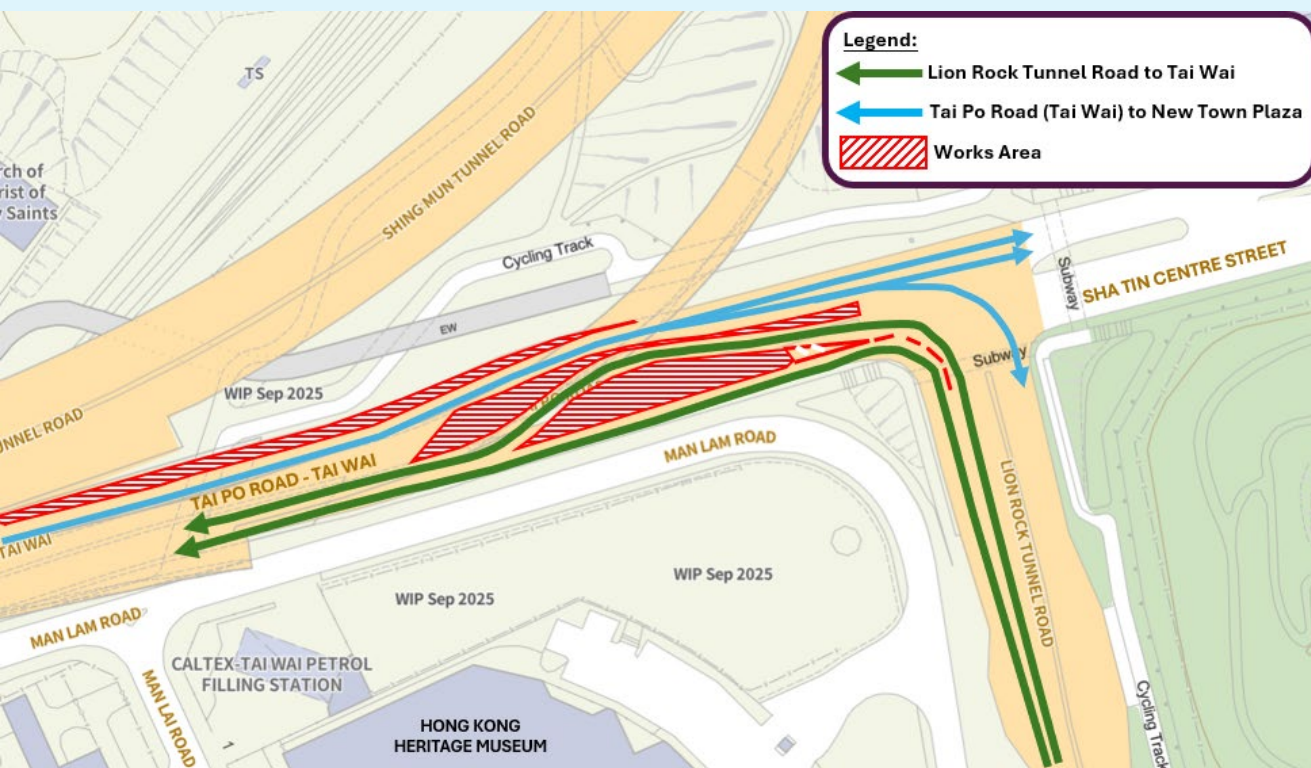

**Temporary diversion:
Left-turn from Lion Rock Tunnel Road
towards Tai Po Road – Tai Wai**



**Temporary closure:
Section of fast lane of Tai Po Road–Tai Wai
(Eastbound)**

